

## PerfectEtch-E

### Instructions for Use

#### **IMPORTANT**

Read this 'Instructions for Use' document before handling. This product is for use by dental professionals only.

**SPECIALLY FORMULATED FOR USE IN DENTISTRY**

#### **IDENTIFICATION**

Thixotropic 37% phosphoric acid etch gel with optimum level of viscosity. Syringe presentation with special tips allows placement of the etching gel in any desired location.

Product Name	PerfectEtch-E
Company Name	Perfection Plus Ltd
Company Address	6 Westwood Court, Brunel Road, Totton, Hampshire, SO40 3WX, UK
Company Phone No.	+44 (0) 2380 866 677

#### **PRODUCT CODE - REF**

010/0090 12g Syringe and 10 disposable etch tips.

010/0092 60g Syringe and 50 disposable etch tips

#### **INDICATIONS FOR USE**

Thixotropic 37% phosphoric acid etch gel is used during dental restoration procedures by professionals, for tooth surface etching (enamel and or dentin).

#### **CONTRA INDICATIONS**

Do not use if patient is allergic to product or to any of the ingredients.

#### **INSTRUCTIONS FOR USE**

NOTE! Do not use if primary package is broken. It is recommended to use a dental dam during application of the product.

Preparation:

1. Prepare surface as usual. The working area must be kept dry.
2. If the surface to be etched is not freshly exposed, cleaning with Perfection Plus Oil Free Prophylaxis Paste is recommended.
3. As illustrated below, once engaged securely twist applicator tip to the syringe.

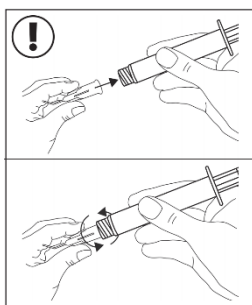

4. Flow small amount of gel on mixing pad.

Etching:

5. Delicately push on plunger and apply layer of etch to all surfaces to be etched. Do not force plunger.
6. Leave etch gel in place for 15 seconds (dentine), 30 seconds (enamel).
7. Rinse with water and dry with air.
8. Verify etched surface is clean and dry.
9. Use an adhesive such as Connect-E or Connect+.

#### **STORAGE**

Keep container tightly closed in dry well-ventilated place between 4-28°C. Protect from direct sunlight and heat sources. Dispose of contents/container as required by national regulatory requirements. Keep out of the reach of children!



#### **WARNING!**

Hazard and precautionary statements:

PerfectEtch-E contains phosphoric acid, which causes skin corrosion, severe skin burns and eye damage.



- IF ON SKIN (or hair): Remove/Take off immediately all contaminated clothing. Rinse skin with water/shower. Wash contaminated clothing before reuse.
- IF SWALLOWED: Rinse mouth. Do NOT induce vomiting. Subsequently, have the casualty drink 1 - 2 glasses of water immediately. Do not try to neutralize with bases, no charcoal.
- IF IN EYES: Rinse cautiously with water for several minutes. Remove contact lenses if present and easy to do. Continue rinsing. Immediately call a POISON CENTER or doctor/physician.

Prevention:

Wash hands thoroughly after handling. Wear protective gloves / protective clothing / eye protection / face protection.

**Caution**



Should a serious incident in relation to the product occur, it should be reported to the manufacturer and the competent authority.

**Batch code/Expiry Date**

See packaging for batch and expiry date. Do not use after expiry date. Please quote this batch number in all correspondence.



Perfection Plus Ltd  
6 Westwood Court  
Brunel Road  
Hampshire  
SO40 3WX, UK  
[www.perfectionplus.com](http://www.perfectionplus.com)



Perfection Plus EU Ltd  
The Black Church  
St Mary's Place.  
Dublin, Ireland,  
D07 P4AX  
[Regulatory@perfectionplus.com](mailto:Regulatory@perfectionplus.com)



Advena Ltd  
Tower Business  
Centre  
2nd Floor Tower  
Street  
Swatar, Malta

